

CardMate^{Plus}TM

Accessories with NetMasterTM



Everything you need to make cashless and m

CardMate™ Value Center (CVC) and CVC Accessories



CVC Base Unit - (CVC/BASE/R1)
CardMate™ Value Center Base Unit includes the smart-card reader and allows users to view their user card balance. With the optional kits listed, the unit can dispense and add value to user cards and print receipts. The CVC can be mounted on a stand, or in the wall for rear loading. Credit card and ATM card capability is also available.

CVC Stand - (CVC/STAND)
Sturdy stand used with the CVC Base Unit makes this system a convenient floor-standing model. Allows for easy placement without wall mounting or taking up valuable counter space.



Bill Acceptor Kit - (CM1077)

Bill acceptor allows customers to purchase CardMate™ Laundry Cards as well as add value to existing cards. Accepts \$1, \$5, \$10 and \$20 bills.

Canadian Bill Acceptor Kit - (CM1088)

Same unit as the CM1077 Bill Acceptor Kit except it accepts Canadian currency only.

CVC Card Dispenser Kit - (CVC/CDK)
Allows CVC Base Unit to dispense CardMate™ Laundry Cards to customers.

Collector Cable - (CVC/COLCBL)
Used to connect your computer to the CVC.

CVC Printer Kit - (CVC/PRK)
Prints receipts for each transaction. Gives your customers peace of mind and helps verify accuracy of transactions. Receipt required by regulation E for credit card use.

Paper Kit for CVC Printer - (CVC/PRK/PAPER)
Thermal paper rolls for use with CVC printer. Kit includes six rolls of paper.

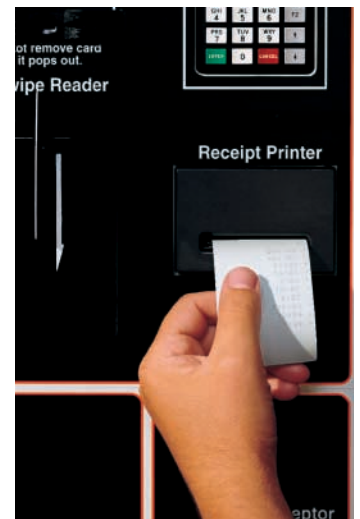

your laundry room operation more profitable.

CardMate™ Service Center (CSC) and CSC Accessories



CSC Base Unit - (S/CSC/AV/R2)

CSC Base Unit with bill acceptor and smart-card reader can view and add value to existing user cards with cash only. The CSC can also dispense cards with the optional card dispenser kit.

Card Dispenser Kit - (CSC/CDK)

Adds card dispenser function to the CSC Base Unit. Customers can purchase CardMate™ Laundry Cards with cash only.

Communications Kit - (CSC/COM/232)

Needed for direct connection with a PC via a cable. Assists in laundry room management.

Collector Cable - (CVC/COLCBL)

Used to connect a PC to the CSC/COM/232.



Readers, Cards and Software

Management Reader - (CM1087)

Smart-card reader to hookup to PC for reading cards and running SERV and Set-Up Software.



User Card - (201035P)

CardMate™ Laundry Cards are used by your customers to operate the laundry equipment.

Multi-Purpose Card - (200671)

Card used to perform diagnostics, for programming laundry equipment and can also be used for a collection card. (Replaces MicroWand)



SCTM Access Card - (200817)

Card used with management reader to access the SmartCard transaction module of the SmartCard suite software.

Set Site Code Card - (S/SITECRDP)

Card used to set the unique site code for the CVC Unit and CSC Unit.

NetMaster SmartCard Suite - (200771)

Software package allows you to work with Multi-Purpose cards, and also read and add value to user cards.

NetMaster Base Suite Software - (200768)

Software package used for full audit and business management functions. Compatible with all audit machines offered by Alliance.

CardMate^{Plus}TM

Accessories with NetMasterTM

CardMateTM Value Center (CVC) and CVC Accessories

<i>Model Number</i>	<i>Model Description</i>
CVC/BASE/R1	CVC Base Kit
CM1077	Bill Acceptor Kit
CM1088	Canadian Bill Acceptor Kit
CVC/STAND	CVC Stand
CVC/CDK	CVC Card Dispenser Kit
CVC/COLCBL	Collector Cable
CVC/PRK	CVC Printer Kit
CVC/PRK/Paper	Paper Kit for CVC Printer

CardMateTM Service Center (CSC) and CSC Accessories

<i>Model Number</i>	<i>Model Description</i>
S/CSC/AV/R2	CSC Base Unit
CSC/CDK	Card Dispenser Kit
CSC/COM/232	RS232 Communications Kit
CVC/COLCBL	Collector Cable

Readers, Cards and Software

<i>Model Number</i>	<i>Model Description</i>
CM1087	Management Reader
201035P	User Card
200671	Multi-Purpose Card
200817	SCTM Access Card
S/SITECRDP	Set Site Code Card
200771	NetMaster SmartCard Suite
200768	Base Suite Software

CardMate^{Plus}TM

Due to continuous product improvements, design and specifications subject to change without notice.



www.comlaundry.com

Shepard Street, Ripon, WI 54971

Telephone: 1-800-345-5649

1-920-748-3121

Fax: 1-920-748-4411