

Equipment Sizing Ratios

Equipment Guidelines by Property Type

One Set

is defined as one topload or frontload washer paired with one dryer pocket, or one stacked washer/dryer
If multiple sets are needed, use the following examples as your guide:

Examples of Multiple Sets

- 2 ea. topload/frontload washerswith 1 ea. stacked dryer (= 2 dryer pockets)
- 2 ea. topload/frontload washerswith 2 ea. single load dryers (= 2 dryer pockets)
- 2 ea. topload/frontload washerswith 1 ea. tumbler dryer (1 tumbler pocket = 2 dryer pockets)

One Washer/Dryer Set is Recommended For the Following:

Property Type	Number of Living Units
High-rise building	20 to 25 living units
Low-rise or garden building	8 to 12 living units
Co-ops, condominiums	8 to 12 living units
Senior citizen centers	50 residents
Military housing	20 military personnel
College residence halls	30 to 40 students
Guest services	50 rooms
In-apartment	1 set per unit

Equipment Guidelines by Property Demographics*

Predominant Resident Profile	Washers & Dryers (W/D) Per Using Unit
Families	1 pair W/D per 8 to 12 units
Young working adults	1 pair W/D per 10 to 15 units
Older working adults	1 pair W/D per 5 to 20 units
Students	1 pair W/D per 25 to 40 students
Senior citizens	1 pair W/D per 25 to 40 units

Determine the number of machines your community needs by adding all units without an in-unit washer/dryer and divide in half the units with in-unit laundry connectons. These figures are based on the predominant resident profile. Adjust according to your particular profile mix.

* Multi-Family Executive

Suggested Floor Plans

HIGH-RISE BUILDINGS

(central laundry room)

Typical 400-unit high-rise apartment building

Activation: Smart-Card

Control: NetMaster Control with touch pad

Model Line: CardMate™

Equipment: Topload and Frontload Washers* and Tumblers

* Front control washers and dryers are ADA Compliant.

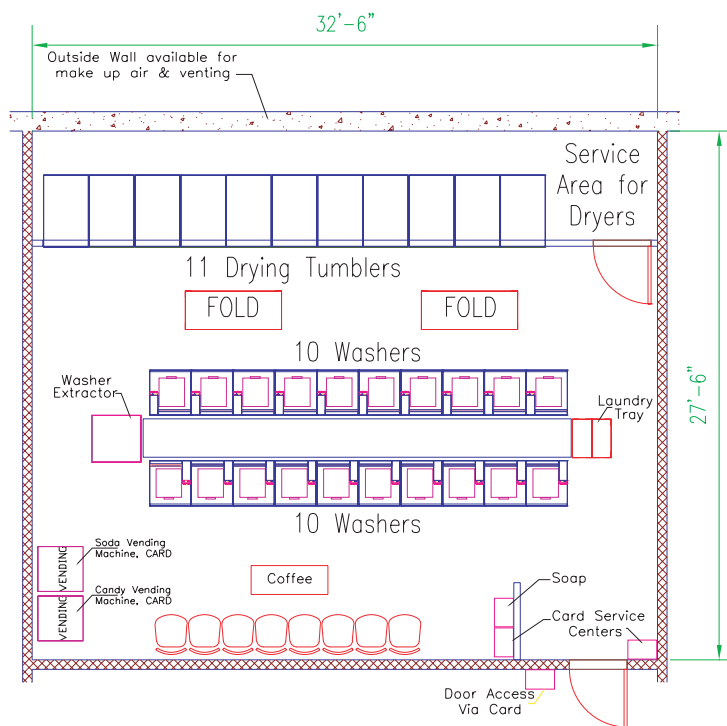
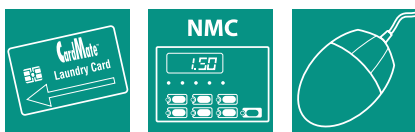

HIGH-RISE CONDOMINIUM

(de-centralized laundry)

Typical 120-unit multiple level housing facility

Activation: Coin Drop

Control: NetMaster Control with touch pad

Model Line: NetMaster

Equipment: Horizon Stacked Washers/Dryers

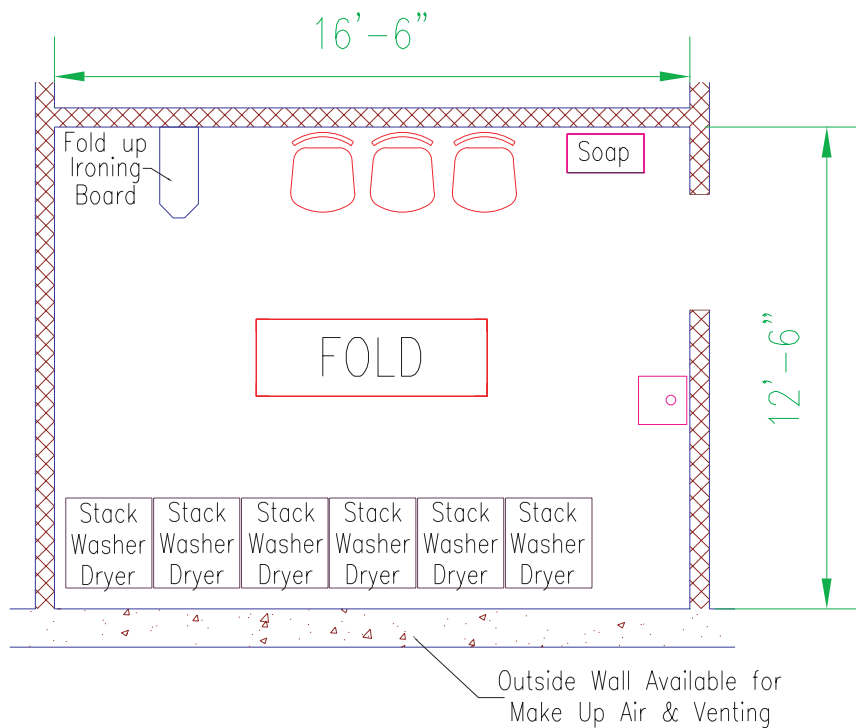
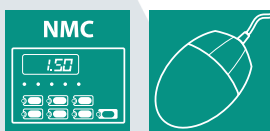

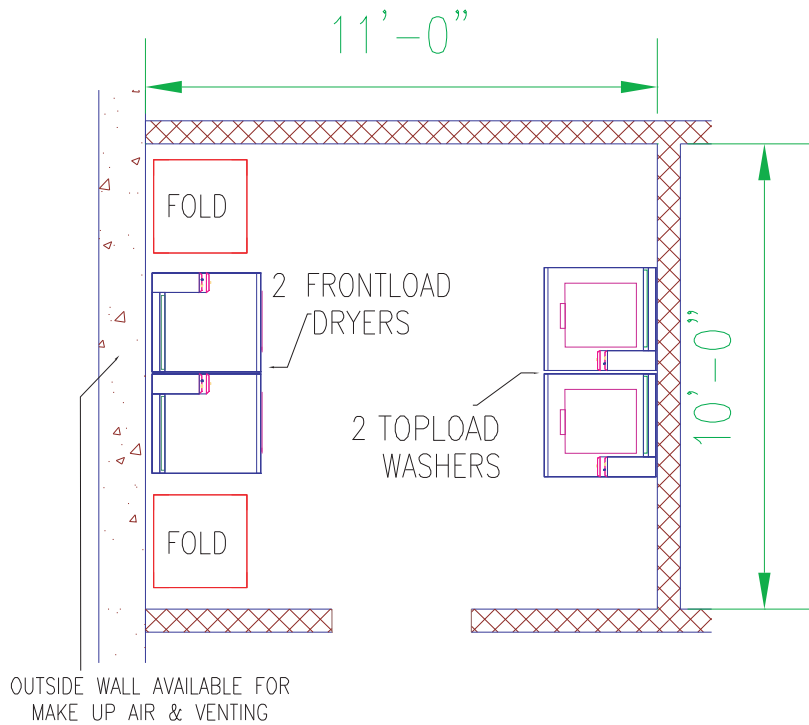

LOW-RISE OR GARDEN BUILDINGS

Typical 20-unit multiple bedroom

Activation: Coin Slide

Control: Rotary Switches

Model Line: Electromechanical

Equipment: Topload Washers and Single Load Dryers

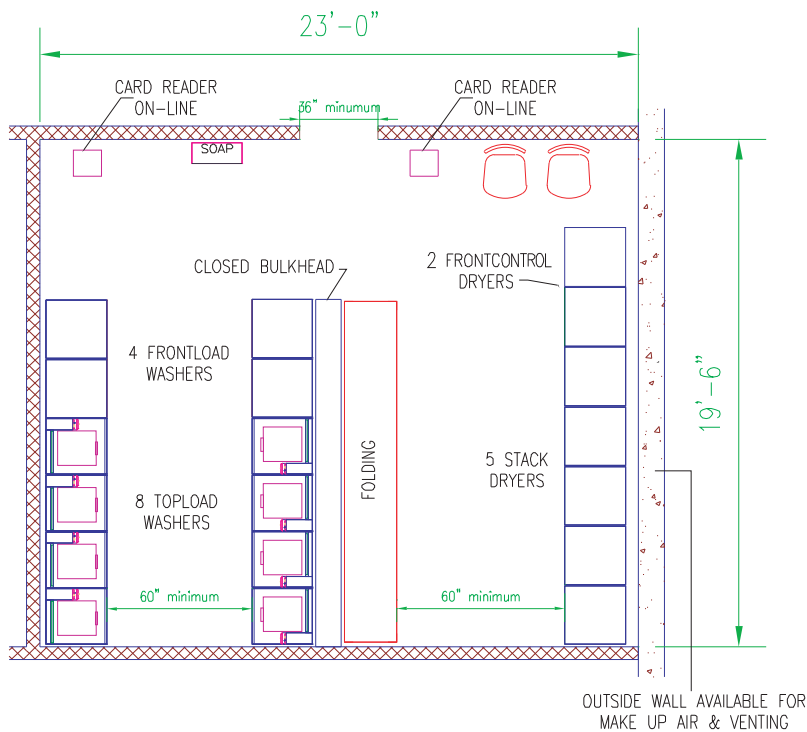

RESIDENCE HALLS (central laundry room)

Typical central laundry room

Activation: Coin Drop or On-Line Debit Card Reader

Control: NetMaster Control with touch pad

Model Line: NetMaster

Equipment: Horizon Frontload and Topload Washers* with Stack Dryers

* Front control washers and dryers are ADA Compliant.

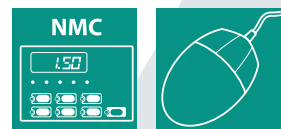

Suggested Floor Plans Cont.

NETMASTER WASH ALERT™ SYSTEM

Web site call back technology of machine availability for residence laundry rooms.



Data Flow

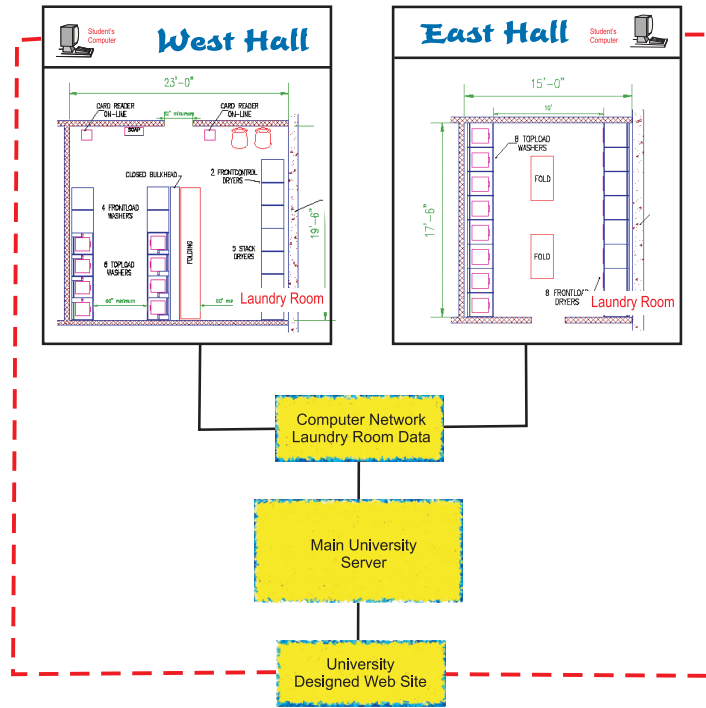

Total Network Link = 4,000 ft. or ¾ mile – 249 Machines Per Computer

MILITARY HOUSING

(central laundry room-BEQ's or BOQ's)

Typical barrack facility

Activation: Push/Pull-to-Start Knob

Control: Rotary

Model Line: Commercial Manual Control

Equipment: Topload Washers and Single Load Dryers

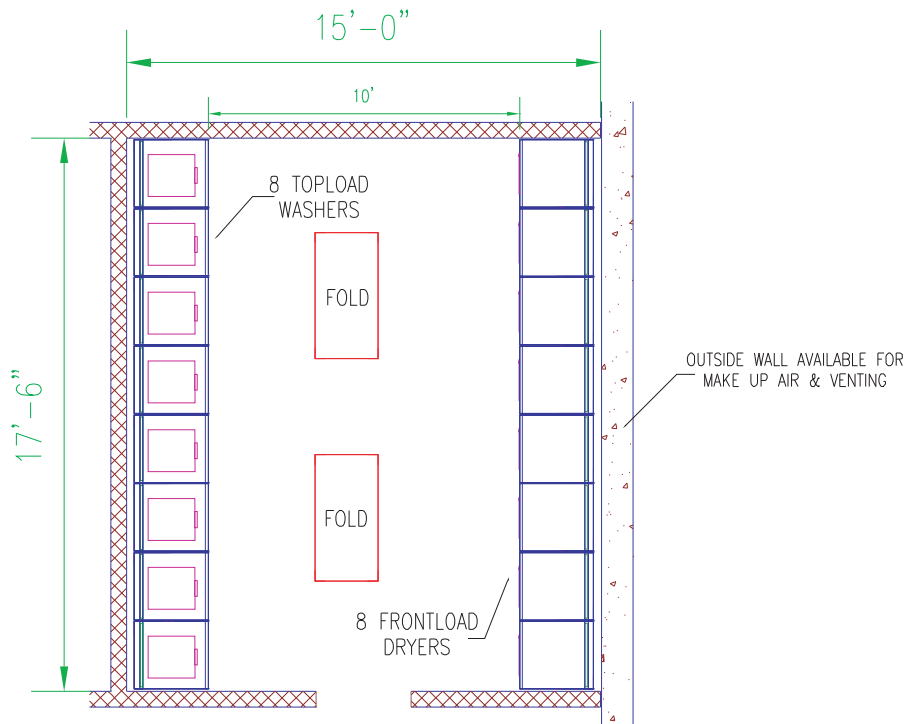

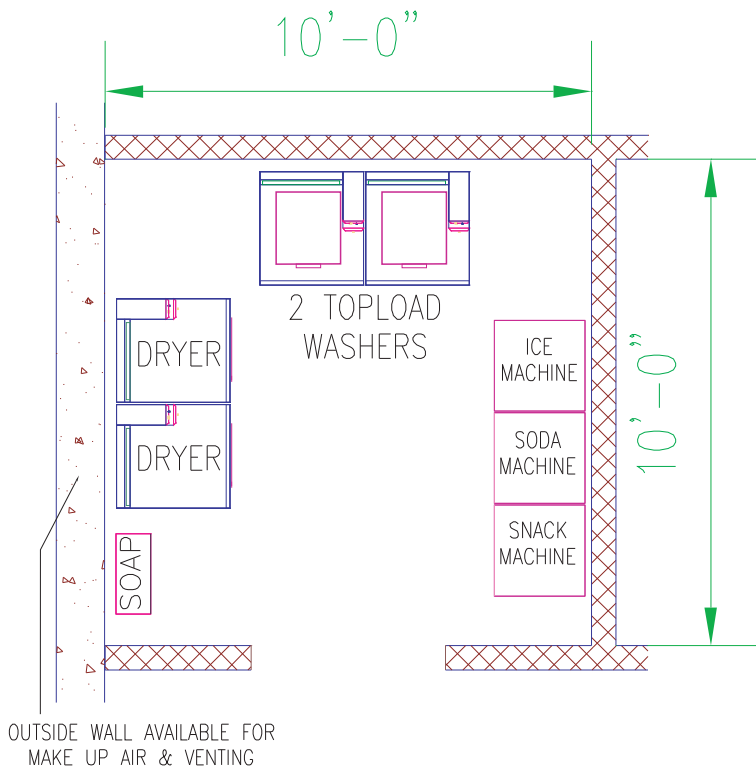

GUEST SERVICES

(hotels, motels, campgrounds, marinas, truck stops)

Typical guest service for vended laundry-hotel/motel

Activation: Coin Slide

Control: Rotary Switches

Model Line: Electromechanical

Equipment: Topload Washers and Single Load Dryers

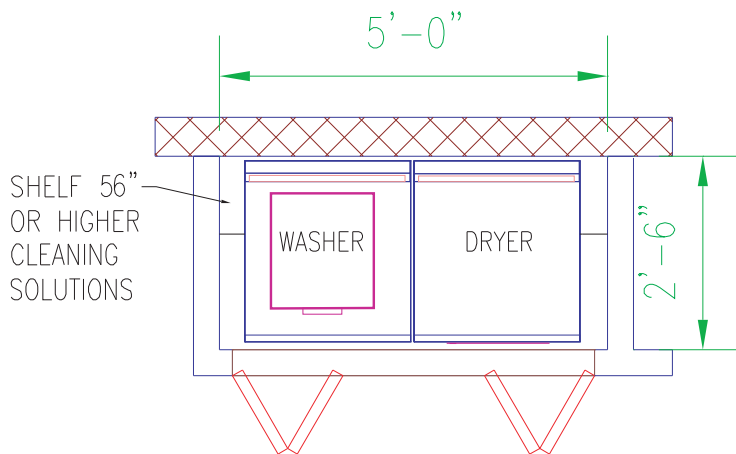

IN-UNIT APARTMENT/CONDO WASHER AND DRYER

Typical in-apartment side-by-side laundry facility

Activation: Push/Pull-to-Start Knob

Control: Rotary

Model Line: Commercial Manual Control

Equipment: Topload or Frontload Washer* and Single Load Dryer

* Front control washers and dryers are ADA Compliant.

