

# Drying Tumblers

25 Pound Capacity

30 Pound Capacity

35 Pound Capacity

Stacked 30 Pound Capacity

Through Serial No. 0602004143

Refer to Page 5 for Model Numbers

— **Operation/Maintenance** —

**NOTA:** Para bajar una copia de estas instrucciones en español, visite [www.comlaundry.com](http://www.comlaundry.com).

**Keep These Instructions for Future Reference.**

(If this machine changes ownership, this manual must accompany machine.)



[www.comlaundry.com](http://www.comlaundry.com)

Part No. 70269501R3  
August 2006





Installation must conform with local codes or in the absence of local codes with:

In the U.S.A., installation must conform to the latest edition of the American National Standard Z223.1/ NFPA 54 “National Fuel Gas Code” and Standard ANSI/NFPA 70 “National Electric Code.”

In Canada, installation must comply with Standards CSA-B149.1 or Natural Gas and Propane Code CSA C22.1, latest edition, Canadian Electric Code, Part I.

In Australia, installation must comply with the Australian Gas Association Installation Code for Gas Burning Appliances and Equipment.

	<b>WARNING</b>
<p><b>FOR YOUR SAFETY</b>, the information in this manual must be followed to minimize the risk of fire or explosion or to prevent property damage, personal injury or death.</p> <p style="text-align: right;">W033</p> <ul style="list-style-type: none"><li>• Do not store or use gasoline or other flammable vapors and liquids in the vicinity of this or any other appliance.</li><li>• <b>WHAT TO DO IF YOU SMELL GAS:</b><ul style="list-style-type: none"><li>– Do not try to light any appliance.</li><li>– Do not touch any electrical switch; do not use any phone in your building.</li><li>– Clear the room, building or area of all occupants.</li><li>– Immediately call your gas supplier from a neighbor’s phone. Follow the gas supplier’s instructions.</li><li>– If you cannot reach your gas supplier, call the fire department.</li></ul></li><li>• Installation and service must be performed by a qualified installer, service agency or the gas supplier.</li></ul> <p style="text-align: right;">W052</p>	
<p><b>FOR YOUR SAFETY</b></p> <p>Do not store or use gasoline or other flammable vapors and liquids in the vicinity of this or any other appliance.</p> <p style="text-align: right;">W053</p>	

	<b>MISE EN GARDE</b>
<p><b>POUR VOTRE SÉCURITÉ</b>, veuillez à bien respecter les indications de ce manuel afin de minimiser les risques d’incendie ou d’explosion ou d’écarter les dangers de dommages matériels, corporel ou de mort.</p> <p style="text-align: right;">W033FR</p> <ul style="list-style-type: none"><li>• Ne pas entreposer ni utiliser d’essence ni d’autres vapeurs ou liquides inflammables dans le voisinage de cet appareil ou de tout autre appareil.</li><li>• <b>QUE FAIRE SI VOUS SENTEZ UNE ODEUR DE GAZ :</b><ul style="list-style-type: none"><li>– Ne pas tenter d’allumer d’appareil.</li><li>– Ne touchez à aucun interrupteur. Ne pas vous servir des téléphones se trouvant dans le bâtiment où vous vous trouvez.</li><li>– Évacuez la pièce, le bâtiment ou la zone.</li><li>– Appelez immédiatement votre fournisseur de gaz depuis un voisin. Suivez les instructions du fournisseur.</li><li>– Si vous ne pouvez rejoindre le fournisseur de gaz, appelez le service des incendies.</li></ul></li><li>• L’installation et l’entretien doivent être assurés par un installateur ou un service d’entretien qualifié ou par le fournisseur de gaz.</li></ul> <p style="text-align: right;">W052Q</p>	
<p><b>POUR VOTRE SÉCURITÉ</b></p> <p>Ne pas entreposer ni utiliser d’essence ou autres gaz et liquides inflammables au voisinage de cet appareil ou de tout autre.</p> <p style="text-align: right;">W053FR</p>	

**IMPORTANT:** Information must be obtained from a local gas supplier on instructions to be followed if the user smells gas. These instructions must be posted in a prominent location. Step-by-step instructions of the above safety information must be posted in a prominent location near the tumbler for customer use.



# Table of Contents

<b>Introduction</b> .....	5
Model Identification .....	5
Customer Service.....	6
Wiring Diagram .....	6
Serial Plate Location.....	6
<b>Safety Information</b> .....	7
Explanation of Safety Messages.....	7
Important Safety Instructions .....	8
<b>Operating Instructions</b> .....	11
Emergency Stop Button on CE Models.....	11
Operating Instructions .....	11
Step 1: Clean Lint Screen/Compartment .....	11
Step 2: Load Laundry.....	11
Step 3: Determine Control Type and Temperature Setting .....	11
Step 4: Remove Laundry .....	11
Electromechanical Coin Control.....	12
Electronic Coin Control .....	13
Manual Timer.....	14
Electronic OPL Control .....	15
MDC Coin Control .....	16
MDC Card Control .....	17
NetMaster Coin Control.....	18
NetMaster Card Control.....	19
<b>Maintenance</b> .....	21
Daily .....	21
Monthly.....	23
Quarterly .....	23
Bi-Annually .....	23
<b>Before You Call for Service</b> .....	27
Customer Service.....	27

© Copyright 2006, Alliance Laundry Systems LLC

All rights reserved. No part of the contents of this book may be reproduced or transmitted in any form or by any means without the expressed written consent of the publisher.



# Introduction

## Model Identification

Information in this manual is applicable to these models.

	Gas			Steam		Electric	
<b>25 Pound</b>	HA025L	SA025N	UT025L	HT025S	UT025S	HT025E	UT025E
	HA025N	ST025L	UT025N	HU025S	UU025S	HU025E	UU025E
	HT025L	ST025N	UU025L	ST025S	YT025S	ST025E	YT025E
	HT025N	SU025L	UU025N	SU025S		SU025E	
	HU025L	SU025N	YT025L				
	HU025N	UA025L	YT025N				
	SA025L	UA025N					
<b>30 Pound</b>	HA030L	SA030L	UA030N	HT030S	UT030S	HT030E	UT030E
	HA030N	SA030N	UT030L	HU030S	UU030S	HU030E	UU030E
	HT030D	ST030L	UT030N	ST030S	YT030S	ST030E	YT030E
	HT030L	ST030N	UU030L	SU030S		SU030E	
	HT030N	SU030L	UU030N				
	HU030L	SU030N	YT030L				
	HU030N	UA030L	YT030N				
<b>T30</b>	HAT30L	HUT30L	SAT30N	HTT30S	STT30S	HTT30E	STT30E
	HAT30N	HUT30N	STT30L	HUT30S	SUT30S	HUT30E	SUT30E
	HTT30D	MTT30N	STT30N				
	HTT30L	NTT30N	SUT30L				
	HTT30N	SAT30L	SUT30N				
<b>35 Pound</b>	AT035L	SA035L	UT035L	AT035S	UT035S	HT035E	UT035E
	AT035N	SA035N	UT035N	HT035S	UU035S	HU035E	UU035E
	HA035L	ST035L	UU035L	HU035S	YT035S	ST035E	YT035E
	HA035N	ST035N	UU035N	ST035S	YU035S	SU035E	YU035E
	HT035L	SU035L	YT035L	SU035S			
	HT035N	SU035N	YT035N				
	HU035L	UA035L					
	HU035N	UA035N					

Includes models with control suffixes:

BC – basic electronic, coin	EC – EDC electronic coin	NY – NetMaster, prep for card
BL – basic electronic, central pay	EX – EDC coin ready	OM – OPL micro
BX – basic electronic, prep for coin	EY – EDC card ready	ZC – NetMaster network coin
BY – basic electronic, prep for card	MT – manual timer	ZR – NetMaster network card
CD – rotary coin drop	NC – NetMaster coin	ZX – NetMaster network, prep for coin
CX – prep for coin	NR – NetMaster card	ZY – NetMaster network, prep for card
CY – prep for card	NX – NetMaster, prep for coin	

**Introduction**

**Customer Service**

If literature or replacement parts are required, contact the source from which the machine was purchased or contact Alliance Laundry Systems at (920) 748-3950 for the name and address of the nearest authorized parts distributor.

For technical assistance, call (920) 748-3121.

**Wiring Diagram**

The wiring diagram is located in the junction or contactor box.

Models starting Serial No. 0309\_\_\_\_ or later will have the wiring diagram part number in the lower portion of the electrical data on the serial plate.

**Serial Plate Location**

When calling or writing for information about your product, be sure to mention model and serial numbers. Model and serial numbers are found on serial plate on rear of machine, and inside door hinge. Refer to *Figure 1*.

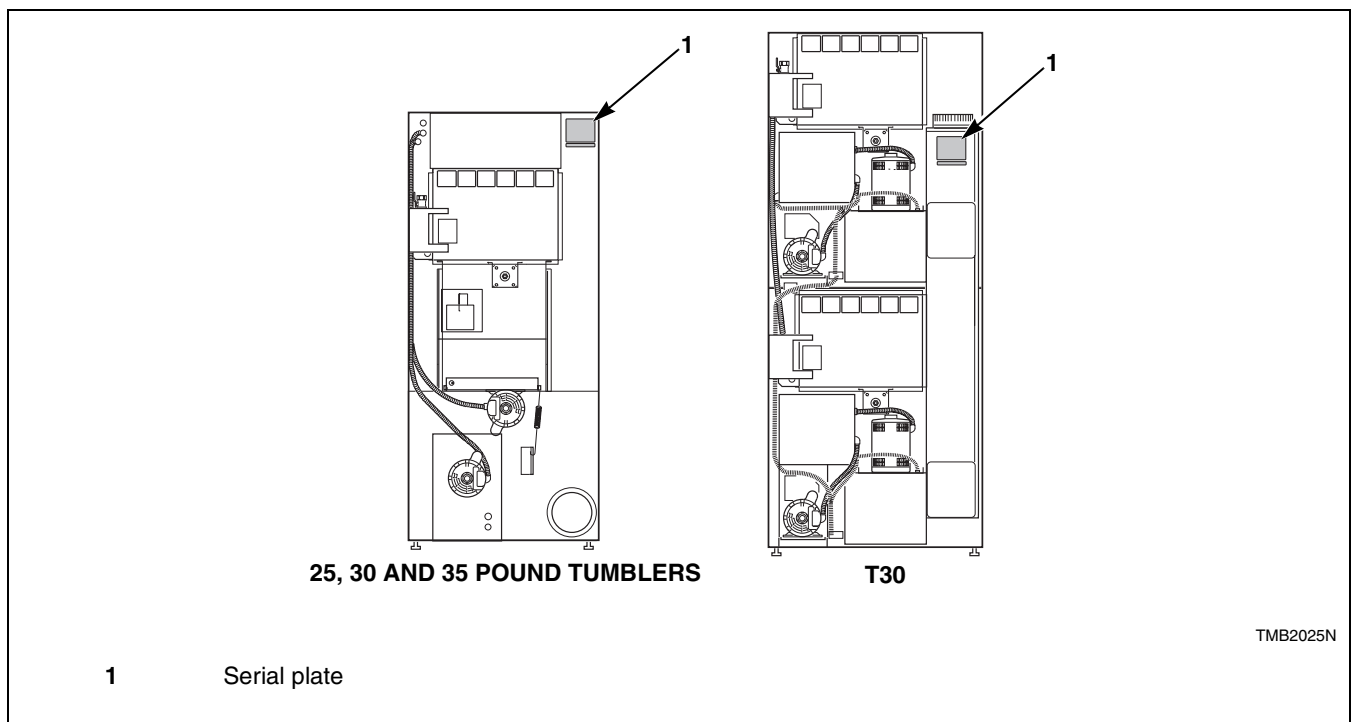

Figure 1

Conversion Table						
Multiply	By	To Obtain		Multiply	By	To Obtain
Btu	0.252	kCal		Pounds/sq. inch	0.06895	Bars
Btu	1055	Joules		Pounds/sq. inch	0.070	kg/sq. cm
Inch	25.4	Millimeters		Pounds (lbs.)	0.454	Kilograms
Inches W.C.	0.036	Pounds/sq. inch		Boiler Horsepower	33,479	Btu/hr.
Inches W.C.	0.249	kPa		Boiler Horsepower	34.5	lbs. steam/hr.
lb/inch <sup>2</sup> (psi)	6.895	kPa		CFM	0.471	liters/second
ft <sup>3</sup>	28.32	Liters		kW	3414	Btu/hr.





# Safety Information

## Explanation of Safety Messages

Precautionary statements (“DANGER,” “WARNING,” and “CAUTION”), followed by specific instructions, are found in this manual and on machine decals. These precautions are intended for the personal safety of the operator, user, servicer, and those maintaining the machine.

	<b>DANGER</b>
Indicates an imminently hazardous situation that, if not avoided, will cause severe personal injury or death.	

	<b>WARNING</b>
Indicates a hazardous situation that, if not avoided, could cause severe personal injury or death.	

	<b>CAUTION</b>
Indicates a hazardous situation that, if not avoided, may cause minor or moderate personal injury or property damage.	

Additional precautionary statements (“IMPORTANT” and “NOTE”) are followed by specific instructions.

**IMPORTANT:** The word “IMPORTANT” is used to inform the reader of specific procedures where minor machine damage will occur if the procedure is not followed.

**NOTE:** The word “NOTE” is used to communicate installation, operation, maintenance or servicing information that is important but not hazard related.

**IMPORTANT:** Warranty is void unless tumbler is installed according to instructions in the *Installation Manual*. Compliance with minimum specifications and requirements detailed herein, and with applicable local gas fitting regulations, municipal building codes, water supply regulations, electrical wiring regulations, and any other relevant statutory regulations. Because of varied requirements, applicable local codes should be thoroughly understood and all pre-installation work arranged for accordingly.

	<b>WARNING</b>
Failure to install, maintain, and/or operate this machine according to manufacturer’s instructions may result in conditions which can produce serious injury, death and/or property damage.	
W051R1	

**NOTE:** The WARNING and IMPORTANT instructions appearing in this manual are not meant to cover all possible conditions and situations that may occur. It must be understood that common sense, caution and carefulness are factors which CANNOT be built into this tumbler. These factors MUST BE supplied by the person(s) installing, maintaining or operating the tumbler.

Always contact your dealer, distributor, service agent or the manufacturer on any problems or conditions you do not understand.

## Safety Information

# Important Safety Instructions

### Save These Instructions

	<b>WARNING</b>
<b>Hazardous Voltage. Can cause shock, burn or cause death. Allow machine power to remain off for two minutes prior to working in and around AC inverter drive.</b>	
W359	

1. Read all instructions before using the tumbler.
2. Refer to the **GROUNDING INSTRUCTIONS** for the proper grounding of the tumbler.
3. Do not dry articles that have been previously cleaned in, washed in, soaked in, or spotted with gasoline, dry cleaning solvents, other flammable or explosive substances as they give off vapors that could ignite or explode.
4. Do not allow children on or in the tumbler. This appliance is not intended for use by young children or infirm persons without supervision. Young children should be supervised to ensure that they do not play with the appliance.
5. Before the tumbler is removed from service or discarded, remove the door to the drying compartment and the door to the lint compartment.
6. Do not reach into the tumbler if the cylinder is revolving.
7. Do not install or store the tumbler where it will be exposed to water and/or weather.
8. Do not tamper with the controls.
9. Do not repair or replace any part of the tumbler, or attempt any servicing unless specifically recommended in the user-maintenance instructions or in published user-repair instructions that you understand and have the skills to carry out.
10. Do not use fabric softeners or products to eliminate static unless recommended by the manufacturer of the fabric softener or product.
11. To reduce the risk of fire, **DO NOT DRY** plastics or articles containing foam rubber or similarly textured rubberlike materials.
12. Always clean the lint filter daily.
13. Keep area around the exhaust opening and adjacent surrounding area free from the accumulation of lint, dust and dirt.
14. The interior of the tumbler and the exhaust duct should be cleaned periodically by qualified service personnel.
15. If not installed, operated and maintained in accordance with the manufacturer's instructions or if there is damage to or mishandling of this product's components, use of this product could expose you to substances in the fuel or from fuel combustion which can cause death or serious illness and which are known to the State of California to cause cancer, birth defects or other reproductive harm.
16. Tumbler will not operate with the loading door open. **DO NOT** bypass the door safety switch to permit the tumbler to operate with the door open. The tumbler will stop tumbling when the door is opened. Do not use the tumbler if it does not stop tumbling when the door is opened or starts tumbling without pressing or turning the START mechanism. Remove the tumbler from use and call for service.
17. Tumbler will not operate with lint panel open. **DO NOT** bypass lint panel safety switch to permit the tumbler to operate with the lint panel open.
18. Do not put articles soiled with vegetable or cooking oil in the tumbler, as these oils may not be removed during washing. Due to the remaining oil, the fabric may catch on fire by itself.
19. To reduce the risk of fire, **DO NOT** put clothes which have traces of any flammable substances such as machine oil, flammable chemicals, thinner, etc. or anything containing wax or chemicals such as in mops and cleaning cloths, or anything dry-cleaned at home with dry-cleaning solvent in the tumbler.
20. Use the tumbler only for its intended purpose, drying fabrics.
21. **ALWAYS** disconnect and lockout the electrical power to the tumbler before servicing. Disconnect power by shutting off appropriate breaker or fuse.
22. Install this tumbler according to the **INSTALLATION INSTRUCTIONS**. All connections for electrical power, grounding, and gas supply must comply with local codes and be made by licensed personnel when required.

## Safety Information

23. Remove laundry immediately after tumbler stops.
24. Always read and follow manufacturer's instructions on packages of laundry and cleaning aids. Heed all warnings or precautions. To reduce the risk of poisoning or chemical burns, keep them out of reach of children at all times (preferably in a locked cabinet).
25. Do not tumble fiberglass curtains and draperies unless the label says it can be done. If they are dried, wipe out the cylinder with a damp cloth to remove particles of fiberglass.
26. Always follow the fabric care instructions supplied by the garment manufacturer.
27. Never operate the tumbler with any guards and/or panels removed.
28. **DO NOT** operate the tumbler if it is smoking, grinding, has missing or broken parts.
29. **DO NOT** bypass any safety devices.
30. Solvent vapors from dry-cleaning machines create acids when drawn through the heater of the drying unit. These acids are corrosive to the tumbler as well as to the laundry load being dried. Be sure make-up air is free of solvent vapors.
31. Failure to install, maintain, and/or operate this machine according to the manufacturer's instructions may result in conditions which can produce bodily injury and/or property damage.



### **WARNING**

**To reduce the risk of serious injury, install lockable door(s) to prevent public access to rear of tumblers.**

W055



# Operating Instructions



## WARNING

To reduce the risk of fire:

- DO NOT DRY articles containing foam rubber or similarly textured rubberlike materials.
- DO NOT DRY plastics, anything containing wax or chemicals such as mops and cleaning cloths, or anything dry-cleaned at home with a dry-cleaning solvent.
- DO NOT TUMBLE fiberglass curtains and draperies unless the label says it can be done. If they are dried, wipe out the cylinder with a damp cloth to remove particles of fiberglass.

W076

To reduce the risk of serious injury, allow cylinder to stop before cleaning lint screen.

W412

## Emergency Stop Button on CE Models

All CE approved OPL tumblers are factory equipped with an emergency stop button located on the front panel. Refer to *Figure 2*.

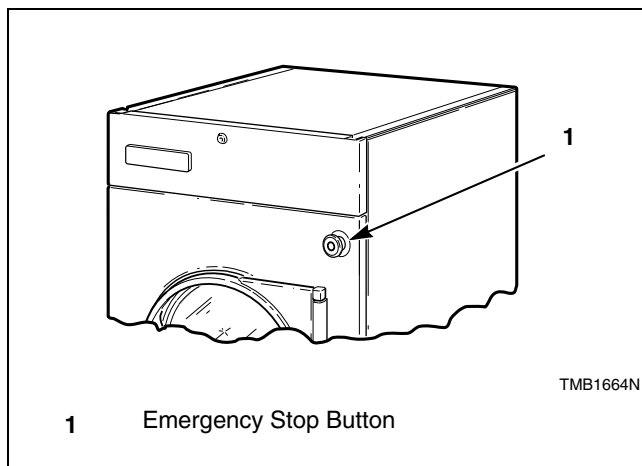

Figure 2

To operate emergency stop button:

- a. Press red emergency stop button to stop all action.
- b. To restart machine, pull red emergency stop button out and press START pad or button.

**NOTE: Activation of the emergency stop button stops all machine control circuit functions, but DOES NOT remove all electrical power from machine.**

## Operating Instructions

### Step 1: Clean Lint Screen/Compartment

Remove any accumulated lint from the lint screen and compartment. Close panel tightly against tumbler frame and lock panel securely, if applicable.

**IMPORTANT: Clean lint screen and lint compartment daily. Failure to clean the lint screen daily will result in higher than normal temperatures that may damage laundry.**

### Step 2: Load Laundry

Open loading door and load cylinder with laundry. DO NOT OVERLOAD.

**NOTE: Overloading causes slow drying and wrinkling.**

Close loading door. Tumbler will not operate with the door open.

### Step 3: Determine Control Type and Temperature Setting

Refer to the various controls, pages 12 - 19, and follow instructions for the appropriate control type.

T30 models only: use the correct coin slot and control panel for the top or bottom cylinder.

The type of fabric being dried will determine the setting. Consult the fabric care label or fabric manufacturer to determine proper temperature setting.

**IMPORTANT: Always follow the fabric care instructions supplied by the garment manufacturer.**

### Step 4: Remove Laundry

When the cycle is complete, open door and remove the laundry.

## Operating Instructions

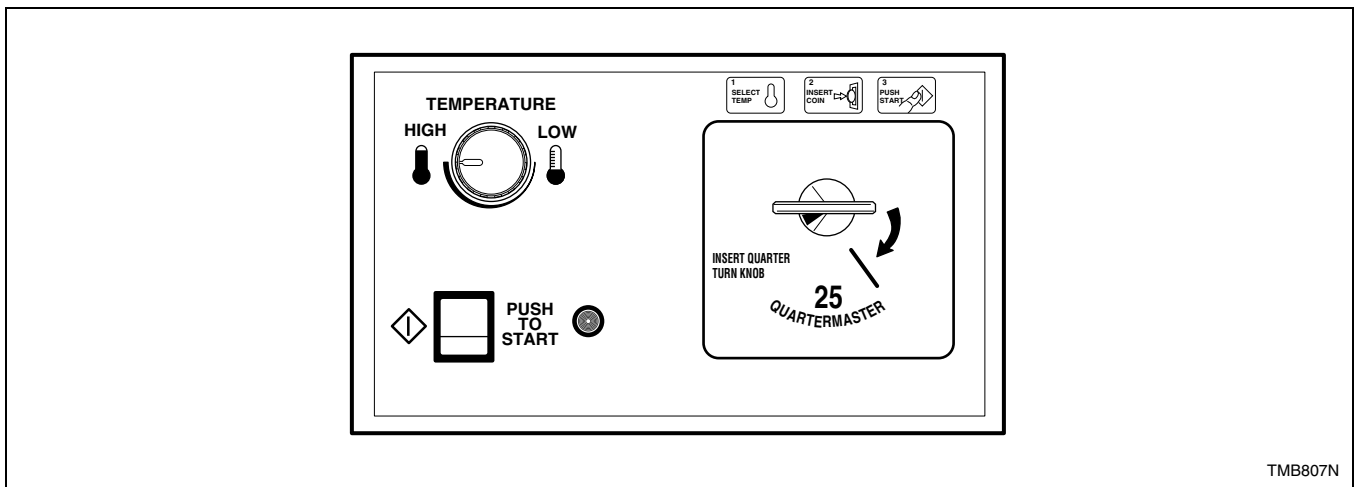

Figure 3

### Electromechanical Coin Control

#### *CD, CX and CY Control Suffixes*

1. Set the TEMPERATURE selector at HIGH or LOW, or anywhere between these settings.
2. Coin Drop Models: Insert the coin(s) in the coin slot, turn the knob to the right and release it.
3. Press the PUSH TO START button and hold it for approximately three (3) seconds.

**NOTE:** Additional drying time may be purchased at cycle start, or while tumbler is running, by adding additional coin(s).

**IMPORTANT:** If the loading door or lint panel door is opened during the cycle, the heating system will shut off and the motor will stop. However, the timer will continue to run. To restart the cycle, both doors must be closed and the PUSH TO START button must be pressed in.

4. When the cycle is complete, open door and remove the laundry.

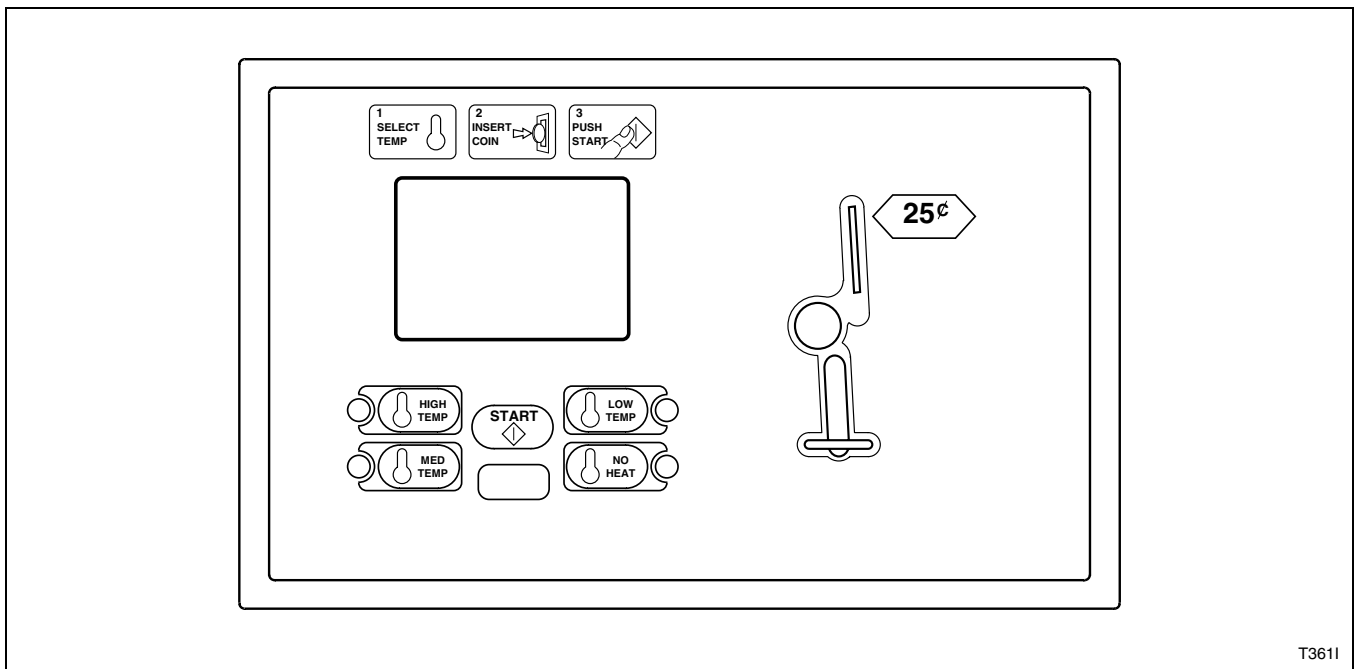

Figure 4

T3611

## Electronic Coin Control

### *EC, EX and EY Control Suffixes*

1. Select HIGH TEMP, MED TEMP, LOW TEMP or NO HEAT by pressing the appropriate temperature pad.
2. Insert the coin(s) in the coin slot.
3. Press START pad to start tumbler.

**NOTE:** Additional drying time may be purchased at cycle start, or while tumbler is running, by adding additional coin(s).

**IMPORTANT:** To stop the tumbler at any time during the cycle, OPEN DOOR. To restart the tumbler, CLOSE door and press START pad.

4. When the cycle is complete, open door and remove the laundry.

## Operating Instructions

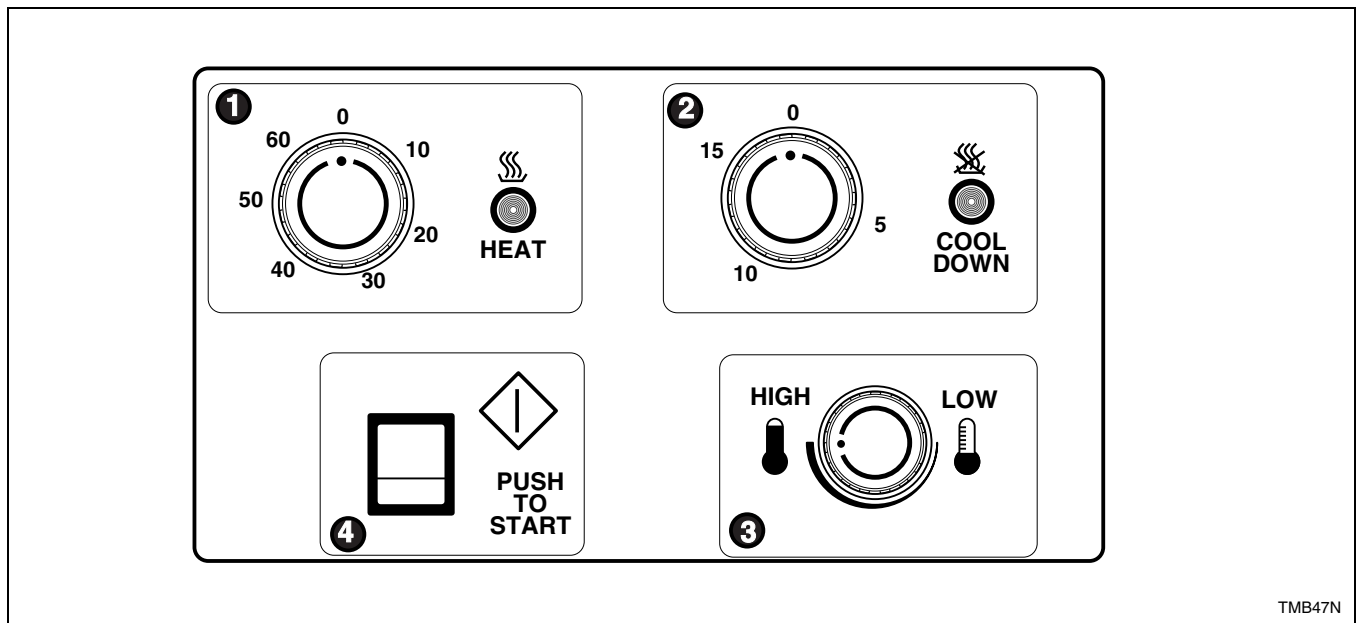

Figure 5

### Manual Timer

#### *MT Control Suffix*

1. Set the HEAT (Drying) timer for the number of minutes (from 0-60) desired.
2. Set the COOL DOWN (Cooling) timer for the number of minutes (from 0-15) desired.
3. Set the Temperature selector at HIGH, LOW or anywhere between these settings.
4. Press the PUSH TO START button in and hold it in for approximately three seconds. This starts the tumbler cycle.

**IMPORTANT: If the door is opened during the cycle, the heating system will shut off and the motor will stop. To restart the cycle, door must be closed and the PUSH TO START button must be pressed in.**

5. When the cycle is complete, open door and remove the laundry.



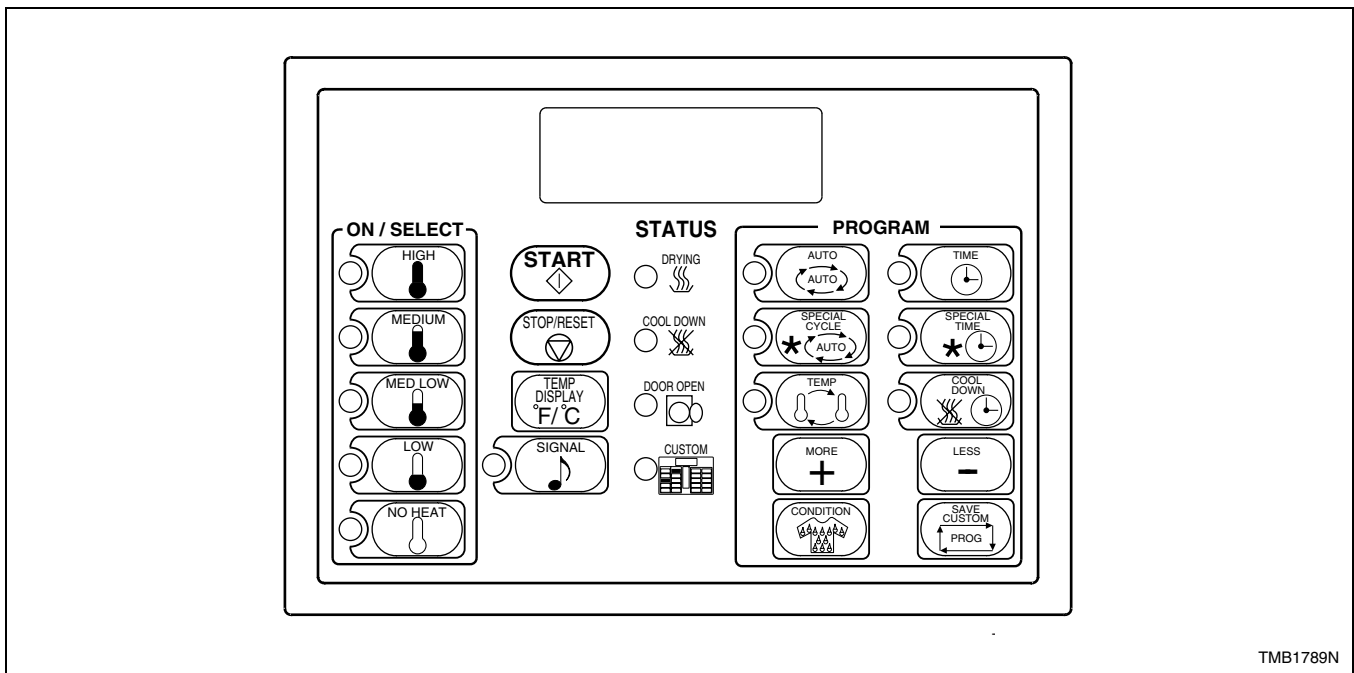

Figure 6

**Electronic OPL Control**

*OM Control Suffix*

1. To use an Automatic Cycle, press an ON/ SELECT pad. Select HIGH, MEDIUM, MED LOW, LOW or NO HEAT for items that should not be dried with heat. A light to the left of the selected pad lights up.

To use a Time Dry or Custom Cycle, refer to the *Programming Manual*.

**NOTE:** Do not press directly on lights or the center of pad. For proper selection, press on pad slightly to the right of center. Refer to *Figure 7*.

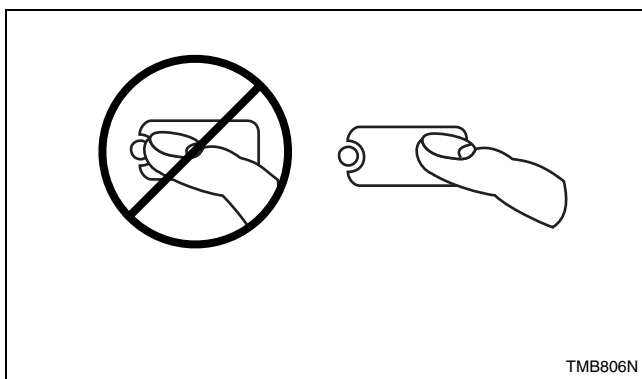

Figure 7

2. Press START pad to start tumbler.

**NOTE:** All pads can be pressed in any sequence without damaging control or tumbler. To stop the tumbler at any time, open the door or press STOP/RESET. The window display will flash. Press STOP/RESET twice (within 3 seconds) to end the cycle and reset the control to idle status. To restart the tumbler, CLOSE door and press START pad.

**IMPORTANT:** If the loading door or lint panel door is opened during the cycle, the heating system will shut off and the motor will stop. To restart the cycle, both doors must be closed and the PUSH TO START button must be pressed in.

3. When the cycle is complete, open door and remove the laundry.

## Operating Instructions

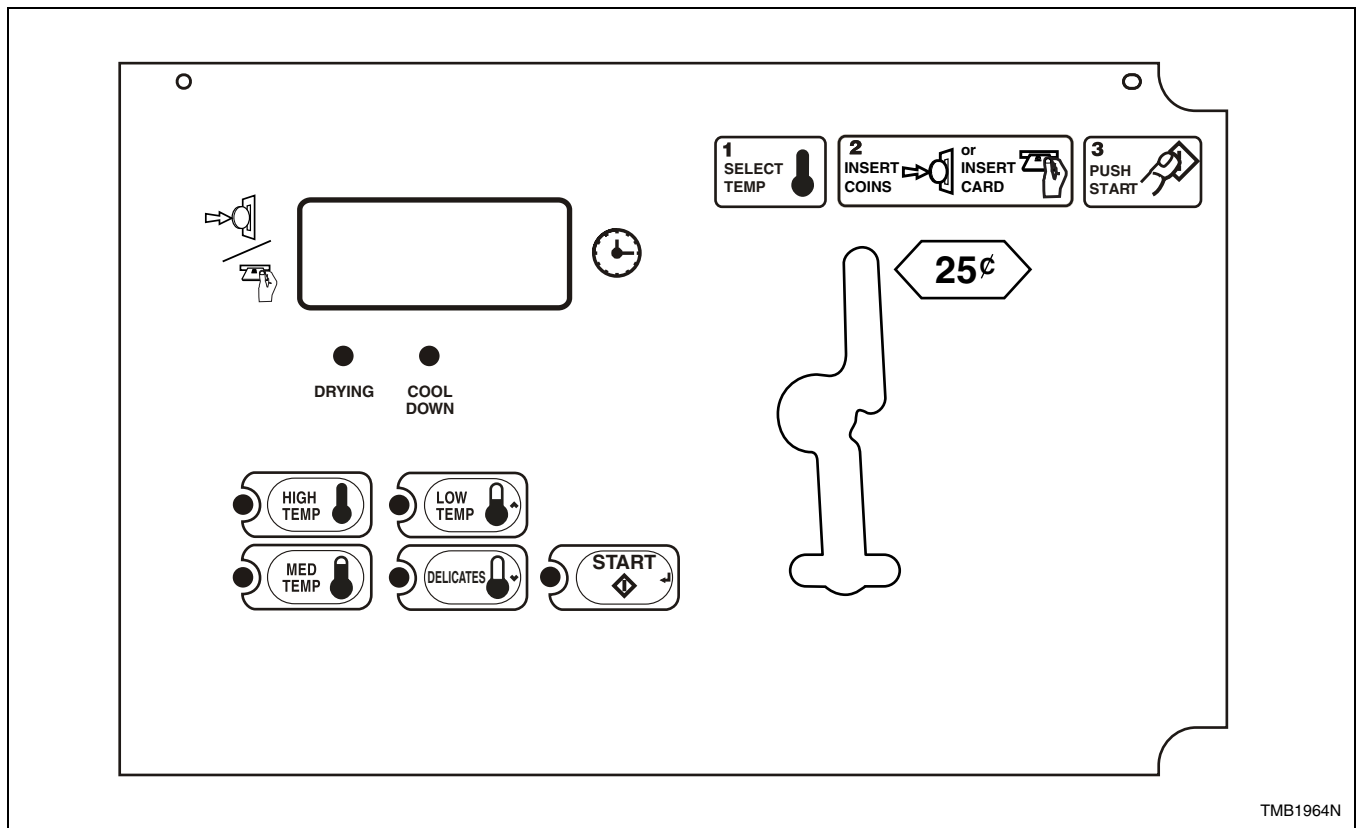

Figure 8

### MDC Coin Control

#### *BC and BX Control Suffixes*

1. Select HIGH TEMP, MED TEMP, LOW TEMP or DELICATES by pressing the appropriate temperature pad.
2. Insert the coin(s) in the coin slot.
3. Press START pad to start tumbler.

**IMPORTANT: To stop the tumbler at any time during the cycle, OPEN DOOR. To restart the tumbler, CLOSE door and press START pad.**

4. When the cycle is complete, open door and remove the laundry.

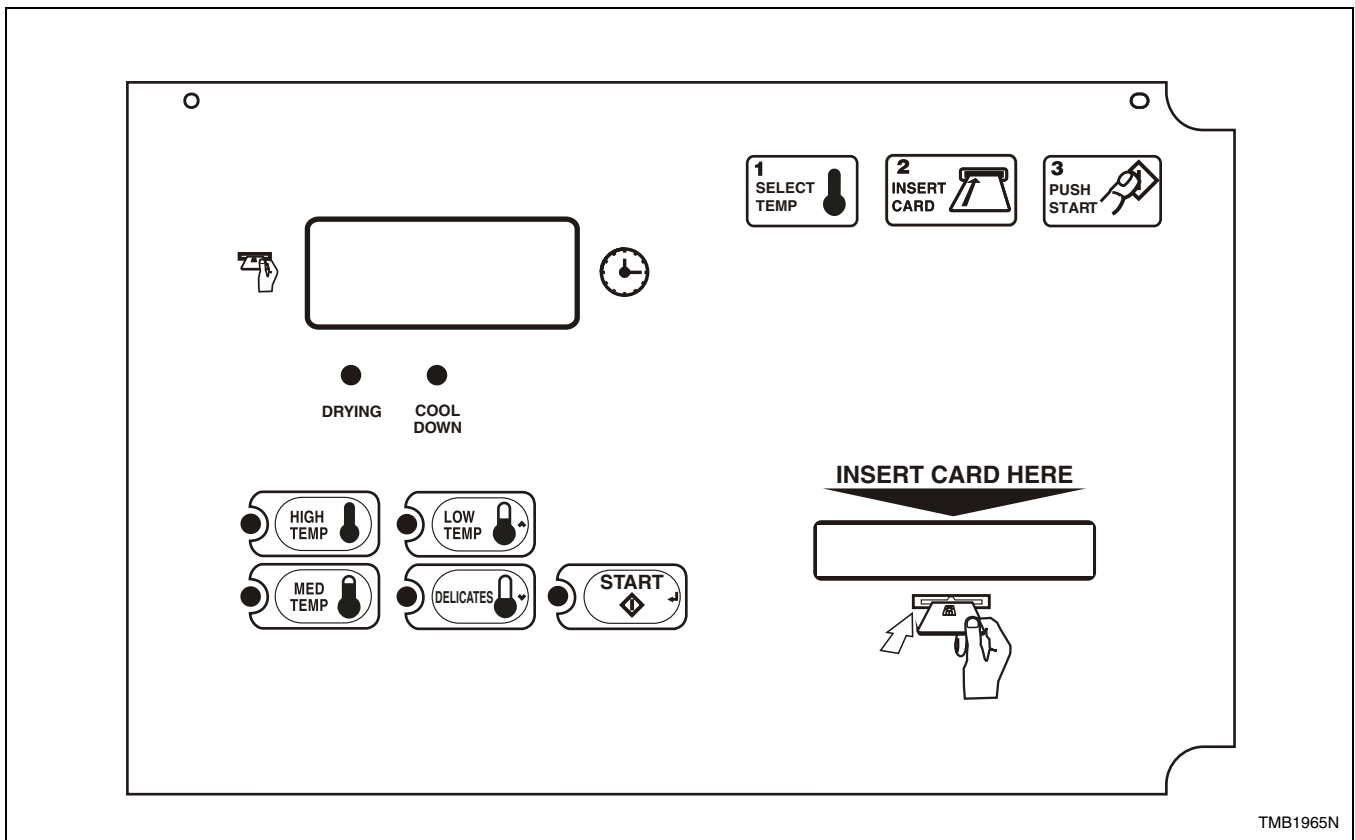

TMB1965N

Figure 9

## MDC Card Control

### *BL and BY Control Suffixes*

1. Select HIGH TEMP, MED TEMP, LOW TEMP or DELICATES by pressing the appropriate temperature pad.
2. Insert card into opening.
3. Press START pad to start tumbler.

**IMPORTANT: To stop the tumbler at any time during the cycle, OPEN DOOR. To restart the tumbler, CLOSE door and press START pad.**

4. When the cycle is complete, open door and remove the laundry.

## Operating Instructions

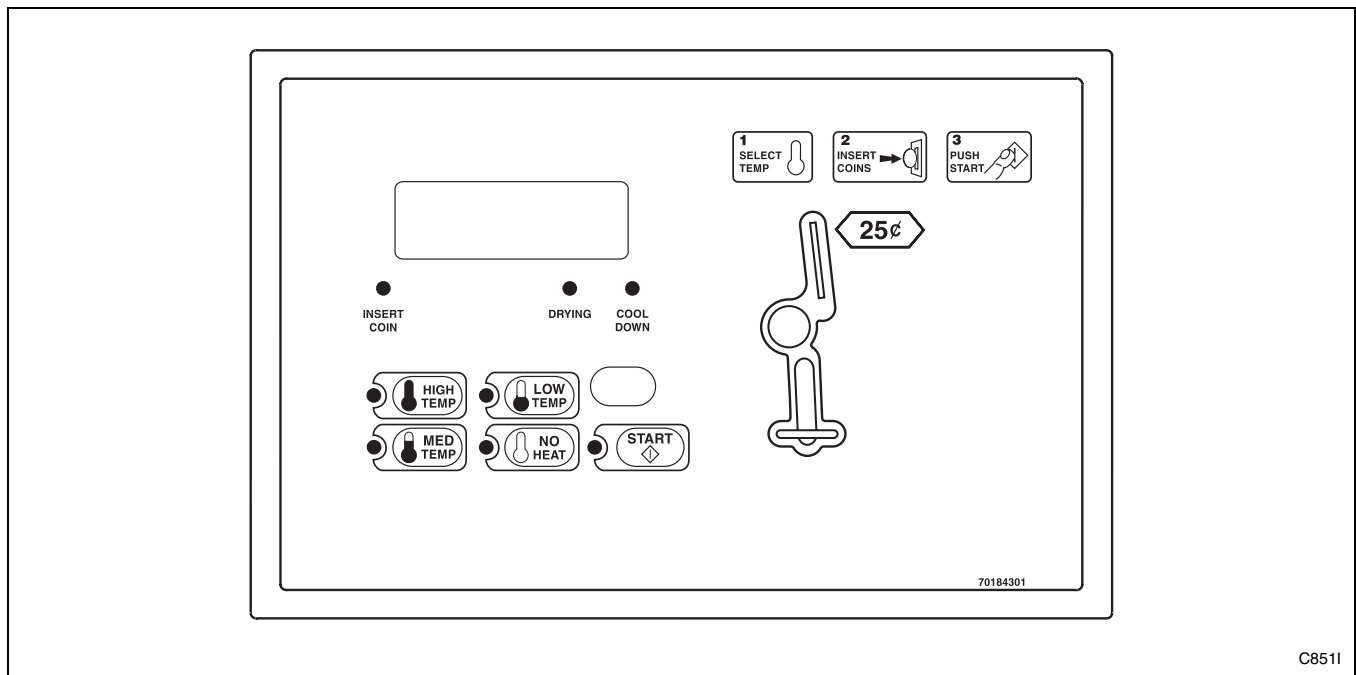

Figure 10

### NetMaster Coin Control

*NC, NX, ZC and ZX Control Suffixes*

1. Select HIGH TEMP, MED TEMP, LOW TEMP or NO HEAT by pressing the appropriate temperature pad.
2. Insert the coin(s) in the coin slot.
3. Press START pad to start tumbler.

**IMPORTANT:** To stop the tumbler at any time during the cycle, **OPEN DOOR**. To restart the tumbler, **CLOSE door** and press **START** pad.

4. When the cycle is complete, open door and remove the laundry.

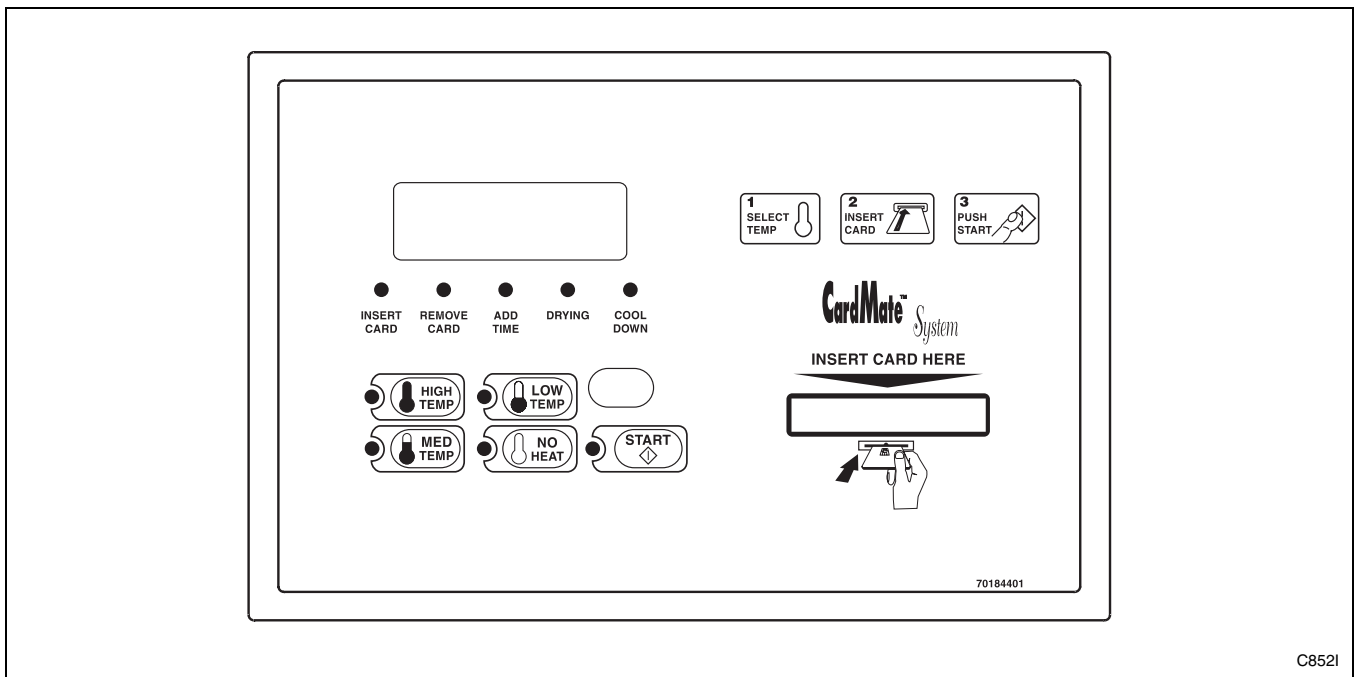

Figure 11

### NetMaster Card Control

*NR, NY, ZR and ZY Control Suffixes*

1. Select HIGH TEMP, MED TEMP, LOW TEMP or NO HEAT by pressing the appropriate temperature pad.
2. Insert card into opening. DO NOT remove the card until "REMOVE CARD" LED is lit.
3. Press START pad to start tumbler.

**IMPORTANT: To stop the tumbler at any time during the cycle, OPEN DOOR. To restart the tumbler, CLOSE door and press START pad.**

4. When the cycle is complete, open door and remove the laundry.



# Maintenance



## WARNING

**To reduce the risk of electric shock, fire, explosion, serious injury or death:**

- **Disconnect electric power to the tumbler before servicing.**
- **Close gas shut-off valve to gas tumbler before servicing.**
- **Close steam valve to steam tumbler before servicing.**
- **Never start the tumbler with any guards/panels removed.**
- **Whenever ground wires are removed during servicing, these ground wires must be reconnected to ensure that the tumbler is properly grounded.**

W002

## Daily

1. Inspect the area surrounding tumblers, remove all combustible materials, including lint, before operating the machines.
2. Check cylinder for foreign objects to avoid damage to clothing and equipment.
3. Clean lint from lint compartment and screen to maintain proper airflow and avoid overheating.
  - a. Open the lint panel or pull out lint drawer.
  - b. Remove all accumulated lint in the lint compartment area. Lightly brush any lint that may be left on the lint screen. Lint left in the lint compartment is drawn back onto the lint screen and will restrict proper air circulation.
  - c. Be sure the lint screen is not torn. If it is, replace immediately. A torn lint screen allows lint to pass from the tumbler to the ductwork system, thus creating a restriction to air circulation.
  - d. The lint screen is designed to completely cover the entire opening in the lint screen panel. Be sure that it does so. Excessive gaps between the lint screen and the lint screen panel allow lint to pass into the ductwork system.
  - e. Carefully wipe any accumulated lint off of the cabinet high limit thermostat and thermistor. Failure to do so will allow a buildup of lint in this area to act as an insulator, causing the tumbler to overheat. Refer to *Figure 12*.
  - f. Replace the lint compartment panel on the tumbler ensuring a tight fit, and lock if applicable.



## WARNING

**To reduce the risk of serious injury, do not open the lint panel while the tumbler is in operation. Before cleaning the lint screen, open tumbler door and allow cylinder to completely stop.**

W410



## WARNING

To reduce the risk of electric shock, fire, explosion, serious injury or death:

- Disconnect electric power to the tumbler before servicing.
- Close gas shut-off valve to gas tumbler before servicing.
- Close steam valve to steam tumbler before servicing.
- Never start the tumbler with any guards/panels removed.
- Whenever ground wires are removed during servicing, these ground wires must be reconnected to ensure that the tumbler is properly grounded.

W002

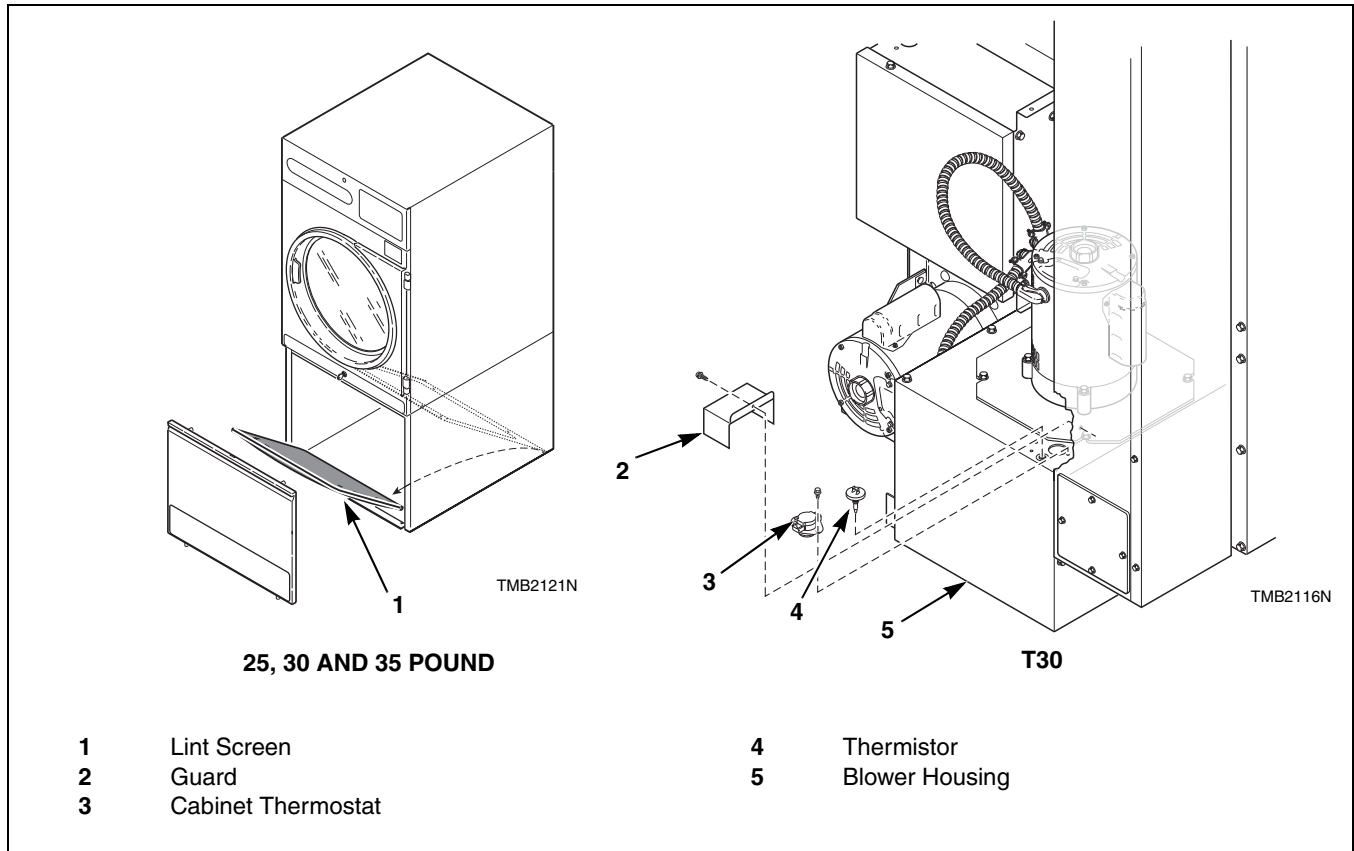

Figure 12





## WARNING

To reduce the risk of electric shock, fire, explosion, serious injury or death:

- Disconnect electric power to the tumbler before servicing.
- Close gas shut-off valve to gas tumbler before servicing.
- Close steam valve to steam tumbler before servicing.
- Never start the tumbler with any guards/panels removed.
- Whenever ground wires are removed during servicing, these ground wires must be reconnected to ensure that the tumbler is properly grounded.

W002

### Monthly

1. Remove lint and debris from inside exhaust duct to maintain proper airflow and avoid overheating.
  - a. Remove external duct and duct access covers, if present.
  - b. Clean inside of duct with a vacuum.
  - c. Clean dampers and make sure they operate freely.
  - d. Replace duct and all access covers before returning to operation.
2. Ensure even lint distribution over lint screen, replace if distribution of lint is uneven to maintain proper airflow and avoid overheating.
3. Carefully wipe any accumulated lint off the cabinet high limit thermostat and thermistor, including perforated cover. Lint buildup will act as an insulator, causing machine to overheat.
4. Clean lint and debris buildup from blower to maintain proper airflow, to avoid overheating and prevent possible vibration.

### Bi-Annually

1. Check mounting hardware for any loose nuts, bolts or screws.
2. Check gas connections for leakage.
3. Check for loose electrical connections.
4. Check steam connections for looseness and leakage.
5. Remove all front panels and vacuum, including coin drop mechanisms.
6. Check cylinder and front panel seals.
7. Inspect cabinet and inner panels for any damage, replace or repair as needed.
8. Clean burner tubes of any lint buildup.

### Quarterly

1. Use a vacuum to clean air vents on drive motors.
2. Use a vacuum to clean lint from rear limit thermostat cover.
3. Refer to Service Manual on how to check and clean steam coils, if applicable.
4. Check flow of combustion and ventilation air.
5. Check belt tension and condition. Replace worn or cracked belts.

**Maintenance**

	<b>WARNING</b>
<p><b>To reduce the risk of electric shock, fire, explosion, serious injury or death:</b></p> <ul style="list-style-type: none"> <li>• <b>Disconnect electric power to the tumbler before servicing.</b></li> <li>• <b>Close gas shut-off valve to gas tumbler before servicing.</b></li> <li>• <b>Close steam valve to steam tumbler before servicing.</b></li> <li>• <b>Never start the tumbler with any guards/panels removed.</b></li> <li>• <b>Whenever ground wires are removed during servicing, these ground wires must be reconnected to ensure that the tumbler is properly grounded.</b></li> </ul>	
W002	

*Daily Maintenance*

Inspect the area surrounding tumblers, remove all combustible materials, including lint, before operating the machine.								
Check cylinder for foreign objects to avoid damage to clothing and equipment.								
Clean lint from lint compartment and screen to maintain proper airflow and avoid overheating.								

*Monthly Maintenance*

Remove lint and debris from inside exhaust duct to maintain proper airflow and avoid overheating.								
Ensure even lint distribution over lint screen. Replace if distribution of lint is uneven to maintain proper airflow and avoid overheating.								
Carefully wipe any accumulated lint off the cabinet high limit thermostat and thermistor, including perforated cover. Lint buildup will act as an insulator, causing machine to overheat.								
Clean lint and debris buildup from blower to maintain proper airflow, to avoid overheating and prevent possible vibration.								



## WARNING

**To reduce the risk of electric shock, fire, explosion, serious injury or death:**

- **Disconnect electric power to the tumbler before servicing.**
- **Close gas shut-off valve to gas tumbler before servicing.**
- **Close steam valve to steam tumbler before servicing.**
- **Never start the tumbler with any guards/panels removed.**
- **Whenever ground wires are removed during servicing, these ground wires must be reconnected to ensure that the tumbler is properly grounded.**

W002

### *Quarterly Maintenance*

Use a vacuum to clean air vents on drive motors.								
Use a vacuum to clean lint from rear limit thermostat cover.								
Refer to Service Manual on how to check and clean steam coils.								
Check flow of combustion and ventilation air.								
Check belt tension and condition. Replace worn or cracked belts.								

### *Bi-Annually Maintenance*

Check mounting hardware for any loose nuts, bolts or screws.								
Check gas connections for leakage.								
Check for loose electrical connections.								
Check steam connections for looseness and leakage.								
Remove all front panels and vacuum, including coin drop mechanisms.								
Check cylinder and front panel seals.								
Inspect cabinet and inner panels for any damage, replace or repair as needed.								
Clean burner tubes of any lint buildup.								



# Before You Call for Service

Won't Start	Won't Heat	Clothes Not Dry	Possible Reason – Corrective Actions
•			Insert correct coin(s) or valid card if applicable.
•			Close the loading door tightly.
•			Close lint panel tightly.
•			Press the PUSH TO START button.
•			Be sure power cord is plugged all the way into the electrical outlet.
•			Drying timer is in OFF position.
•			Check the main fuse and circuit breaker.
•			Check fuses located in the machine.
	•		Insufficient airflow.
	•		Gas shut-off valve in OFF position.
	•		Are controls properly set?
	•		Broken drive belt. Call the service person.
	•	•	Tumbler is in Cool Down Mode.
	•	•	Lint screen clogged. Clean lint screen.
	•	•	Exhaust duct to outside is blocked. Clean out.

## Customer Service

If literature or replacement parts are required, contact the source from which the machine was purchased or contact Alliance Laundry Systems at (920) 748-3950 for the name and address of the nearest authorized parts distributor.

For technical assistance, call (920) 748-3121.

